

INTRODUCING THE NEW ACS A-CLIP®

- ♦ EASIER TO INSTALL
- ♦ ADJUSTABLE FROM ZERO TO 1" IN PRECISE 1/8" INCREMENTS
- ♦ PRE-DRILLED HOLES SAVE TIME AND ENERGY

HOW TO USE THE ADJUSTING FEATURE:

- 1) Install the base piece using attachment screws selected from the ACS Thermal Clip Structural Design Guide.
- 2) Slide the adjustment piece over the base.
- 3) Line the holes up with the desired increment. There will be two holes for each number:

0 = 0" (Min)

1 = 1/8"

2 = 1/4"

3 = 3/8"

4 = 1/2"

5 = 5/8"

6 = 3/4"

7 = 7/8"

8 = 1" (Max)

- 4) Use the #12 self-tapping stainless steel screws provided to lock the adjustment in place. The ACS A-Clip® must be secured with 2 screws.

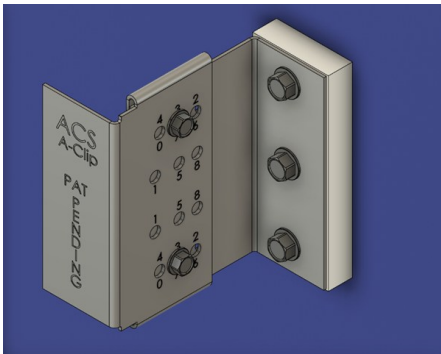

Screws set in the #3 position for a 3/8" adjustment.

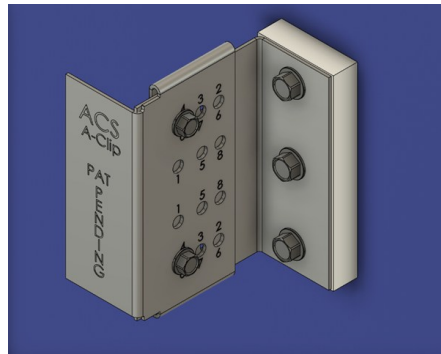

Screws set in the #4 position for a 1/2" adjustment.

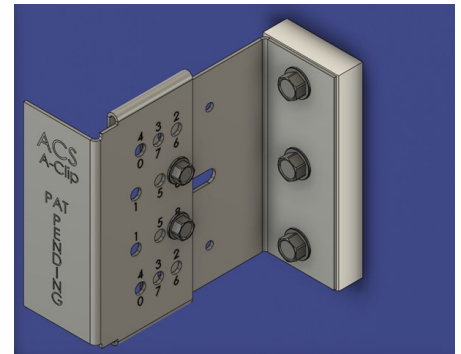

Screws set in the #8 position for a 1" or maximum adjustment.